

Brand : TCK, China
Name : Capacitive sensor cold water tap
Item Code : 201LT47 DC

Designer :

Color / Finish: Chrome

Dimensions : (Please see data drawing below for dimensions)

Product info:

- Capacitive sensor basin tap
- DC 6V
- Solid Brass body
- Flow rate: 7 l/min. at 3 bar
- Flow pressure: 1~5 bar (15~70 psi)

Add-ons:

- 1x angle valve ½"x½" with filter
- 1x basin waste strainer or pop-up
- 1 x basin waste trap

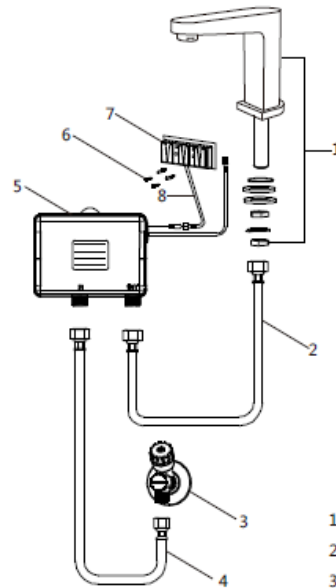
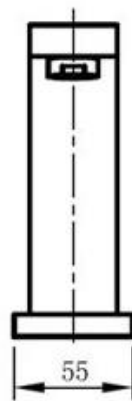
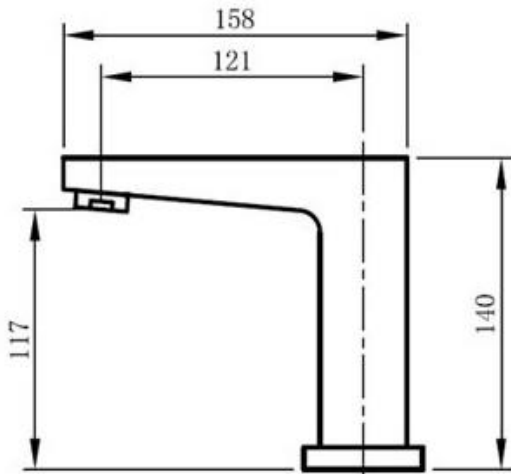

- 1.faucet body and fixing nuts
- 2.insulated flex hose(black)
- 3.angle valve with filter
- 4.insulated flex hose(black)
- 5.control box
- 6.screw
- 7.hanger
- 8.ground wire

Flushing of pipe must be done before fittings are installed. Failure to do so voids the warranty.

Follow cleaning instructions and avoid using any harmful chemicals.

All information is for reference only. Installation shall always be based on the specs provided with actual delivered items.

For more info, visit www.sanitecph.com