

## SPECIFICATION SHEET - fittings

<b>BRAND:</b>	<b>VRH</b>	<b>Product Photo:</b>  
<b>ORIGIN:</b>	Thailand	
<b>SERIES:</b>	<b>PASSO</b>	
<b>PRODUCT DESCRIPTION:</b>	Self-closing basin pillar tap, cold or pre-mixed water Flow rate: 7 lpm at 3 bar Flow pressure: 1~3 bar	
<b>MODEL No.</b>	R5000S2	
<b>FINISH/COLOUR:</b>	304 Stainless steel	
<b>DIMENSIONS:</b>	124mm height 76mm spout projection	
<b>OPTIONAL MATCHING PARTS:</b>	1x angle valve 1/2"x1/2" (no nuts) 1x flexible supply hose 1/2"x1/2" x?cm 1x basin waste strainer or pop-up 1x basin waste trap	

### Technical Informations:

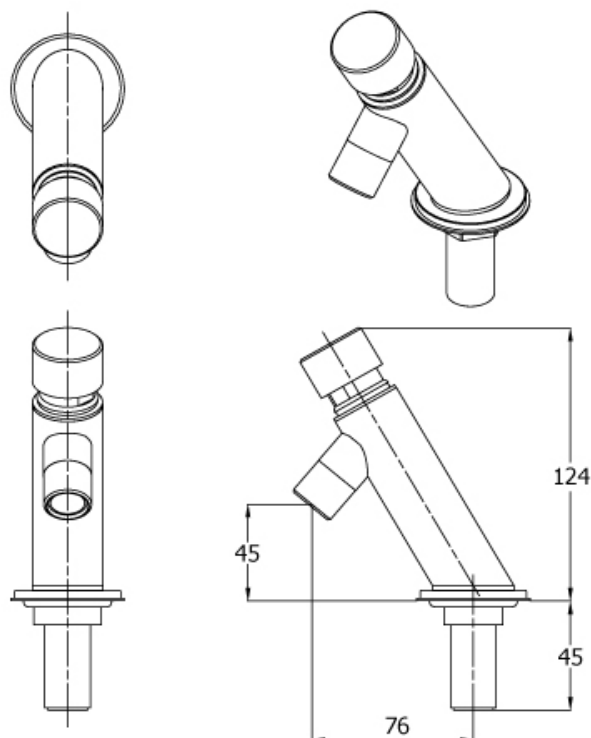

<b>REMINDER:</b>	Pipe flushing must be done before faucets are installed. Failure to do so voids the warranty.
	Do not use cleaners containing abrasive cleansers, ammonia, bleach, acids, waxes, alcohol, solvents or other products not recommended for chrome.
	All information is for reference only, installation shall always be based on the actual product delivered.